

**FEEL THE HEAT!**

## Spare Tire Carrier for CanAm Maverick X3

Part # **01-2924 / 2925** Maverick X3 - All Models Black / Red

Congratulations on your purchase of the DragonFire Spare Tire Carrier! Flats are inevitable and not fun. With this simple bolt-on setup, you will be able to bring the spare tire with you and your vehicle will look stylish. Be sure to check out the full line of DragonFire Accessories for your CanAm vehicle at your local authorized dealer or online at <http://www.DragonFireRacing.com>

**M12-1.5 Lug Nuts were not included because of variation in aftermarket wheel size.**



- Read and understand these instructions before installing product
- Do not use as an anchor point for pulling
- Installation may scratch powder coat
- Do not use product if there are any signs of damage

### Disclaimer

Off road activities can be hazardous and could lead to injury, dismemberment, paralysis and death. No warranty of representation is made as to the products ability to protect the user from any injury or death. The user assumes that risk. The acceptance and /or use of this merchandise purchased from DragonFire by the customer hereby shall release DragonFire from any and all liability pertaining to the use of such merchandise.

**Pre-installation:** Lay out components and compare to list and images.

Part & Hardware List					
ITEM	QTY	SIZE	LENGTH	TYPE	STEP USED
P1	1	-	-	Cross Bar	4
P2	1	-	-	Spare Tire Carrier	8
P3	4	1/4"	1/2"	Aluminum Spacer	5
P4	4	1/4"-20	1-1/2"	Hex Bolt	5
P5	8	1/4"	-	Flat Washer	5
P6	4	1/4"-20	-	Hex Nuts	5
P7	6	#10-32	3/4"	Socket Head Cap Screw	8

Tools Required
T40 Torx
7/16" Wrench & Socket
5/32" Allen Wrench
13mm Wrench
Ratchet
Lug Wrench

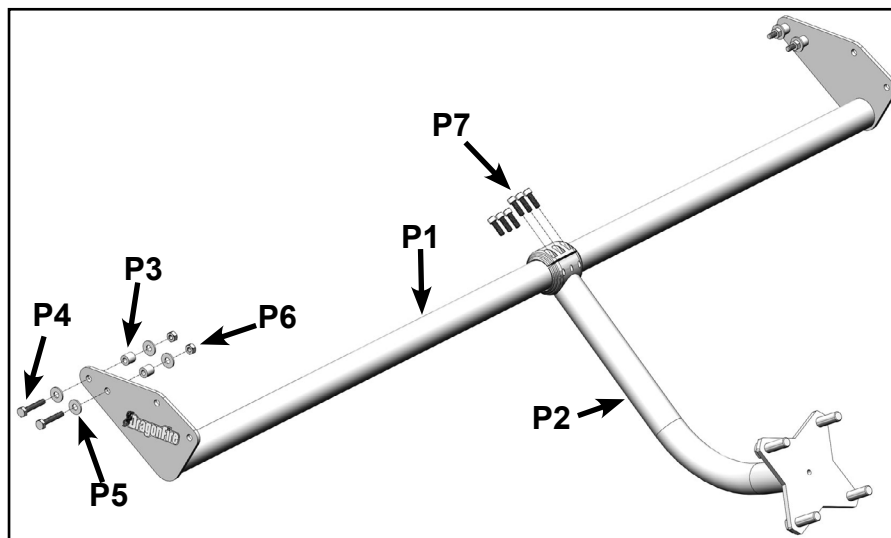

DragonFire

**Step 1:** Place vehicle on a flat and level surface. Place gear selector in "Park" and remove keys from the ignition.

**Step 2:** Locate the Torx bolts on the side of the C-Pillar. (Figure A)

**Step 3:** Remove 4 Torx bolts and nuts. Retain hardware for later use. (Figure B)

**Step 4:** Locate the Cross Bar [P1]. Use hole pattern on the bracket to match with the hole pattern on the vehicle frame. Place P1 between the vehicle frame under where the bolts were removed in the previous step. (Figure C)



**Step 5:** Place 1/4" bolts with washers through the two front-most holes of mount bracket. Place spacer on the bolt between bracket and vehicle frame, then loosely install with washers and nuts. (Figure D) Repeat for opposite side.

**Step 6:** Loosely install factory bolts and nuts retained from Step 3. Repeat for opposite side. (Figure E)

**Step 7:** Torque the 1/4" hex hardware to 9 ft-lbs and factory hardware to factory torque specifications.

**Step 8:** Locate the spare tire carrier [P2]. Use Allen wrench to loosely install it to the desired location on P1. (Figure F)



**Step 9:** Place wheel on studs of P2 and install lug nuts (**not included**). Torque lug nuts to specifications of wheel manufacturer. (Figure G)

**Step 10:** Align P2 and tire at desired location. Ensure Spare Tire Carrier [P2] does not rest on the plastic access covers of vehicle.  
**TIRE MUST REST ON THE BED** (Figure H). Torque the clamp bolts to 32 in-lbs. Gap should be even on both sides of clamp.

**Step 11:** This completes installation. Time to ride and enjoy!

**ProTip:** Periodically check all hardware and re-tighten if needed.

For further assistance please contact us at [customerservice@dragonfireracing.com](mailto:customerservice@dragonfireracing.com) or 1-800-708-9803.

