



SSV WORKS, 201 N. Rice Ave Unit A, Oxnard, CA 93030
www.SSVworks.com | Phone: 818-991-1778 | Fax: 866-293-6751

X3-US10

2016+ Can-Am Maverick x3 10" Under Seat Enclosure

WARRANTY INFORMATION:

All SSV Works enclosures are covered by a limited lifetime warranty against defects in material or workmanship. All SSV Works Electronics are covered by a limited 1 year warranty against defects in material or workmanship. All SSV Works Speakers are covered by a limited 1 year warranty against defects in material or workmanship. Labor for replacement of defective components is not covered. Contact SSV Works for further warranty information.



Please read and understand these instructions completely before installation to avoid possible injury, or damage to the accessory or vehicle.

TOOLS NEEDED FOR INSTALLATION

- 10mm Socket or Wrench
- T-30 Torx Driver
- T-40 Torx Driver

PARTS LIST

- | | | |
|--------------------------|----------------------|------------------------|
| 1. X3-US10 Enclosure | 5. Large washers x 2 | 9. Seat Risers x 2 |
| 2. M6 x 16mm Screws x 10 | 6. D-Brackets x 2 | 10. Small Spacer x 1 |
| 3. M6 Washers x 10 | 7. A-Bracket x 1 | 11. M6 Locking Hex Nut |
| 4. M6 x 25mm Screw x 1 | 8. B-Bracket x 1 | 12. Foam Strips x 3 |

PARTS LIST IMAGES



1. X3-US10 Enclosure



2. M6 x 16mm Screws x 10

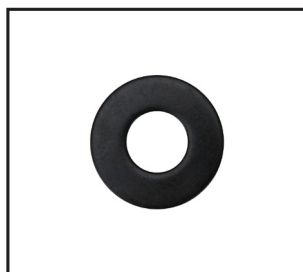

3. M6 Washers x 10



4. M6 x 25mm Screw x 1



5. Large washers x 2



6. D-Brackets x 2



7. A-Bracket x 1



8. B-Bracket x 1



9. Seat Risers x 2



10. Small Spacer x 1



11. M6 Locking Hex Nut

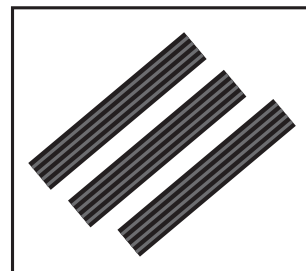

12. Foam Strips x 3

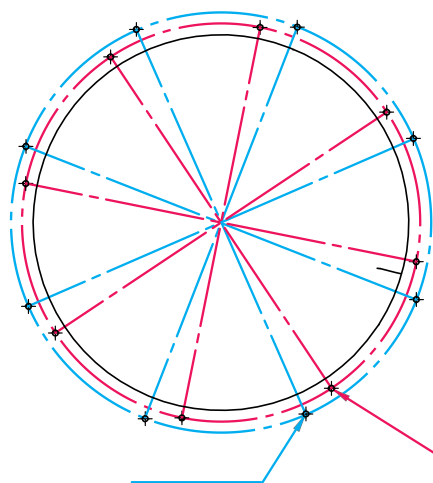

KICKER HOLE PATTERN

SSV HOLE PATTERN

FOR UNLOADED ENCLOSURES:

Pink hole pattern: SSV Works Subwoofer

Blue hole pattern: Kicker Subwoofer

If using a different brand subwoofer, first see if the subwoofer holes line up with either one of the pre-drilled hole patterns. If not, make sure to drill new holes away from the pre-drilled holes. Be sure to use the 8 supplied SSV Works #7 screws when installing your own subwoofer.



#7 Screws x 8



A. Apply the foam strips to the inside right, left and top side of the enclosure.



B. Using the supplied M6 screws and washers, screw the DD-brackets to the bottom right and left side of the enclosure.

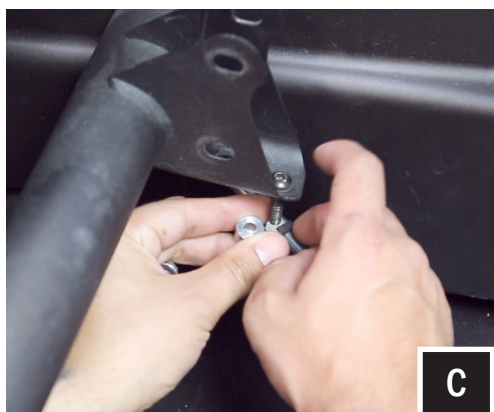

C



C



C

C. Remove the factory 10mm nut and bolt from the brake line. Place the washer on top of the factory bracket and push the long M6x25mm screw through the top. Then attach the brake line, spacer, washer and nut. Then hand tighten.



D. Replace the factory seat bolt spacers with the supplied SSV Works spacers



E. Run the brake line along the dedicated channel on the sub enclosure while feeding the enclosure down under the seat bar (F1). Make any adjustments to the brake line so the enclosure lays on top of it. Line up the rear enclosure brackets to the rear seat bolts and press down until the brackets rest on top of the spacers.

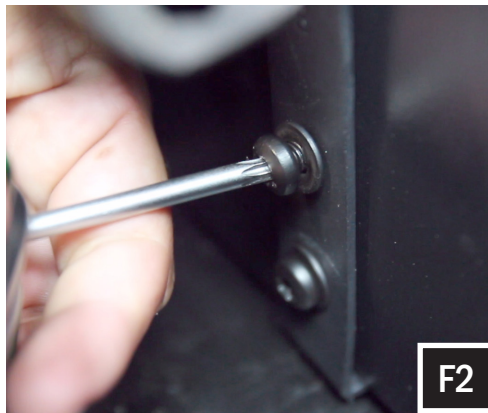

F. Place B-Bracket to the left side of the enclosure and slide the tab underneath the enclosure. (F1) Line up the 2 screw holes and proceed to hand thread the M6 screws and washers. Use a T30 Torx bit to tighten screws. Repeat for the right side. (F2) Line up the top of bracket A and B with the holes on the factory seat bracket. Screw in the M6 screw with the large washer (F3).



G. Route the speaker wire away from any moving parts and any sharp metal, then connect to the amplifier.
Connecting the X3-US10 using the pre-installed, four-pin connector will require an optional SSV Works plug-&-play harness B-H1152 - sold separately).

USING A SSV WORKS HARNESS

Connecting the X3-US10 using the pre-installed, four-pin connector will require an optional SSV Works plug-&-play harness (B-H1152 - sold separately). If you are not using the B-H1152 harness, simply cut off the four-pin connector and follow the wiring instruction below.

WIRING INSTRUCTIONS

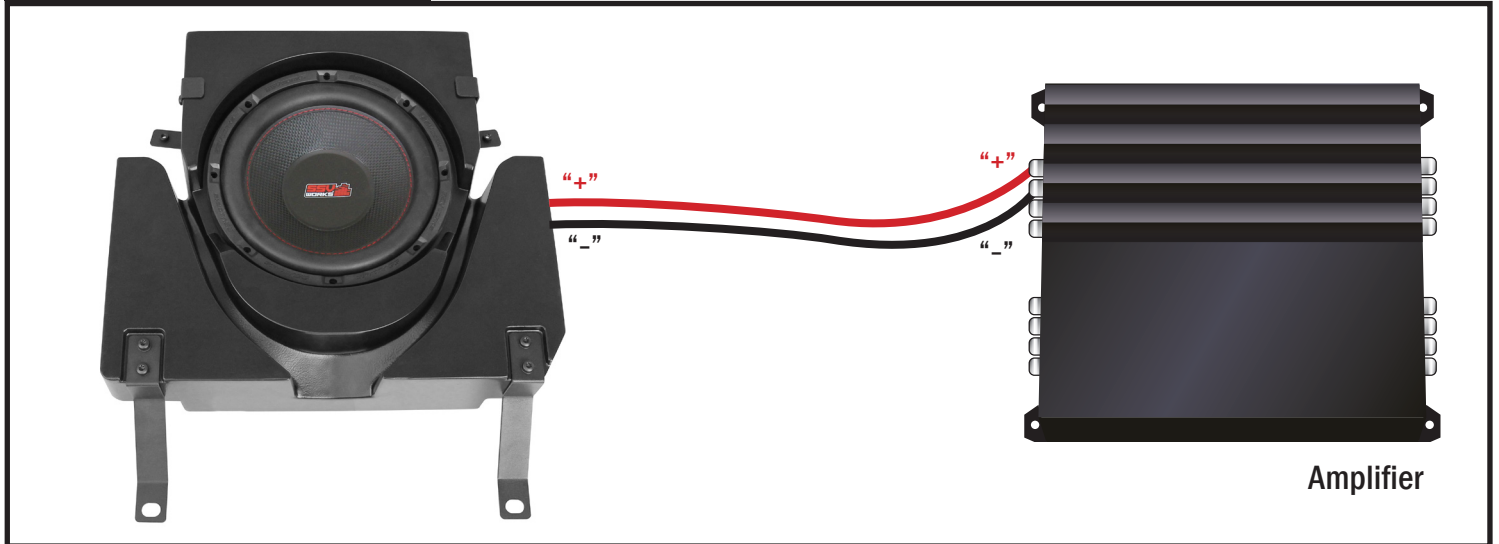

For proper sound, ensure the speaker polarity is correct connect the "+" to the "+" and the "-" to the "-" from the speaker wire to the amplifier. If using with an SSV Works complete system refer to the amplifier wiring instructions for more detailed wiring information.



X3-US10